

Durable, smooth operation and lockable:  
The DIRAK slam latch for sliding doors



## 01 Requirements

“Locking systems for sliding doors must meet several requirements like durability, smooth operation and convenience. Our challenge was to match these attributes precisely and to design the latch so that it is visually appealing as well as lockable.

Our solution: slam latch for sliding doors in different versions. With or without lock, our latches meet the most exacting standards.

Paula Pinto, Key Business Management



## 02 Product Benefits

This locking system offers you convenience and reliability

1. Variable: Oblong holes make it possible to use aluminum profiles of different profile widths
2. Flexible: the oblong holes can also be used for adjustment
3. Convenient: A sufficiently large rear grip makes it easy to open the door simply by pulling on the handle, when wearing gloves for example
4. Easy: To close the door slide it shut
5. Secure: Lockable versions are optionally available keyed alike (DIRAK 1333) or keyed different

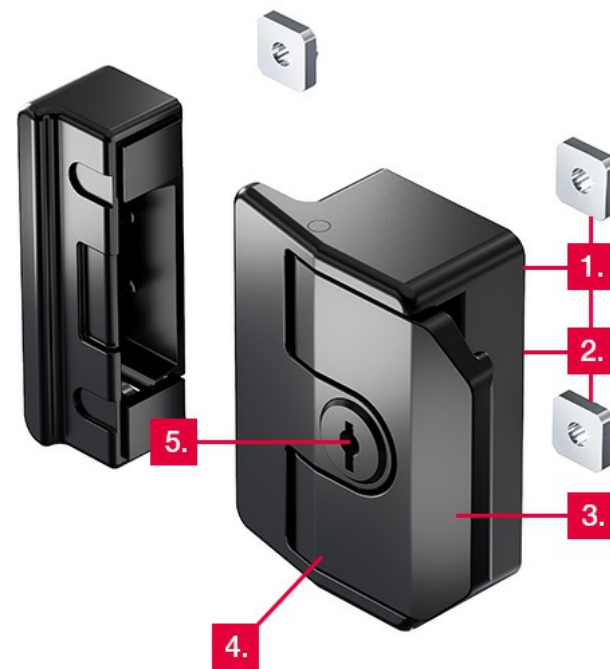

## 03 Application Areas

Our slam latches for sliding doors provide the perfect solution for a wide range of different applications and offer for high-quality latching solutions in all areas.

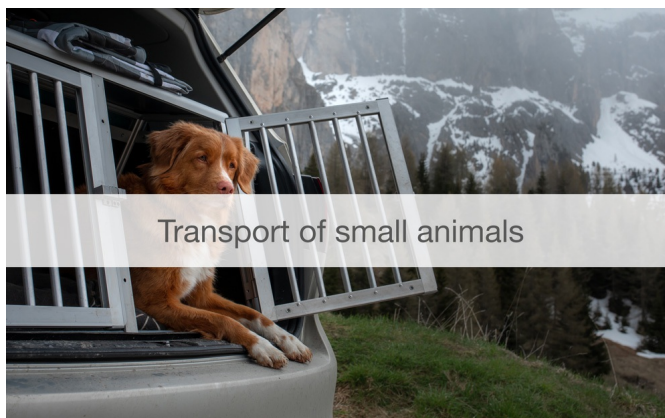
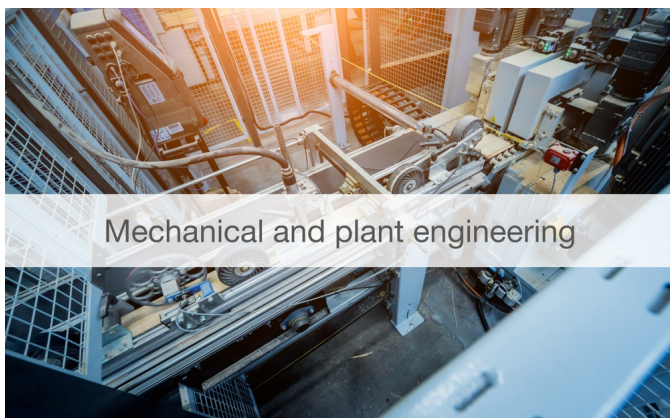

**The best solution for every application**

Are you looking for a slam latch for swing doors?

No problem, simply click [here](#).

## 04 Dimensions / Order Options

### Material

Bolt and locking element: zinc die, black

Slotted nuts: steel, zinc plated

Cylinder barrel: PA, black

Spring: stainless steel



Rectangular profile: polyurethane

### Remarks

4 screws M6 (e.g. DIN 912) and the slotted nuts (1.) included with delivery are used for fastening

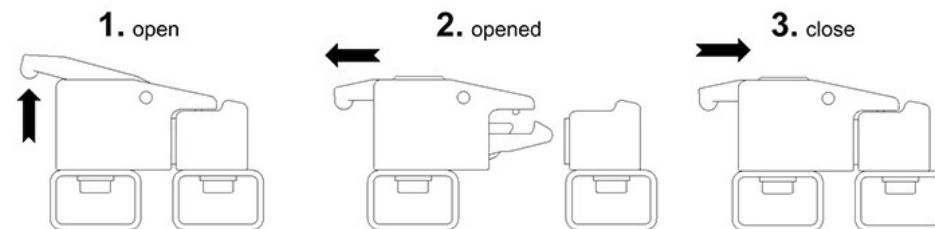
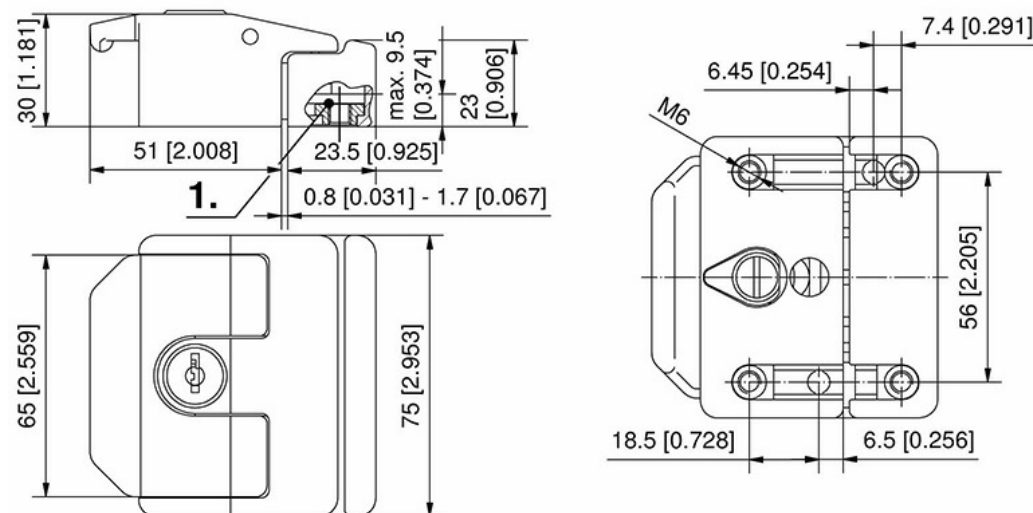
Version with cylinder barrel is supplied with 2 keys



Product System	Latching type	Bolt with freestroke	Installation Type	Part Number	Link
6-152	without lock, with plug	yes	screw-on	265-9610.00.00000	
6-152	keyed alike DIRAK 1333	–	screw-on	265-9610.00.01333	
6-152	keyed different	–	screw-on	265-9610.00.09999	

### Contact

---



DIRAK GmbH –  
A Member of DIRAK Group

DIRAK Dieter Ramsauer  
Konstruktionselemente GmbH  
Königsfelder Straße 1  
58256 Ennepetal  
Germany

Phone: +49 (0) 2333 / 837-0

Fax: +49 (0) 2333 / 837-103

Email: [info@dirak.de](mailto:info@dirak.de)

### Imprint

DIRAK Dieter Ramsauer  
Konstruktionselemente GmbH  
Königsfelder Straße 1  
58256 Ennepetal  
Germany

Phone: +49 (0) 2333 / 837-0  
Fax: +49 (0) 2333 / 837-103  
Email: [info@dirak.de](mailto:info@dirak.de)

Represented by:  
Jens Boche

Entered in the trade register  
Commercial Register AG Hagen,  
HRB 7977  
Sales Tax ID Number (VAT No.)  
DE 261 585 314  
Last update: June 2023